

**VII Parts list(Standard) >>**

1.Remote control 1pcs	2. One pair of battery for remote control
3.Lithium battery 1pcs	4.Lift control cable 1pcs
5.AC and DC cord 1pcs	6. 12VDC battery charger 1pcs
7.Square pin of shuttles holder 1pcs	8.Shuttles holder 1pcs
9.Spanner 1pcs	10.Allen wrench 2pcs
11.Tripod 1pcs	12.Manual 1pcs
13.Warranty card 1pcs	

**VIII Notice**

- ▲ Do not repair the machine or change the machine parts at will, otherwise the machine will be damaged or serious accidents will be caused.
- ▲ Do not use wet balls or damaged balls, otherwise the machine will get stuck or damage the machine.
- ▲ If hit the ball into the machine accidentally,turn off the power right away and then take out the ball.
- ▲ It is forbidden to stand at the ball outlet when the machine is working.
- ▲ Do not move the machine while it is working.
- ▲ It is forbidden to touch the inside of the machine by hand to avoid accidents.
- ▲ Be sure to cut off the power when cleaning the machine, otherwise maybe cause danger.
- ▲ Minors are strictly prohibited from operating the machine without permission to avoid endangering personal safety and damaging the machine.
- ▲ It is forbidden to tear up the machine bar code.

**Caution:**

**If maintenance is required,please contact manufacturer**

**IX Common faults and solutions >>**

FAQ	Cause	Solution
<b>Not start</b>	Power cable is broken or not inserted tightly.	Change or insert again.
<b>Serving two more shuttles together</b>	1.Two shuttles stick together. 2.Shuttles are damaged.	1.Separate the shuttles. 2.Change the new shuttles.
<b>Ball Jammed</b>	1.The holder or shuttles not in the right place. 2.Shuttles are damaged. 3.The tracking chain is stucked.	1.Replace the holder and shuttles. 2.Change the shuttles. 3.Clean the tracking chain.
<b>Holder not rotating</b>	The frequency sensor cannot be inducted	Clean the sensor
<b>Shuttles cannot be picked up</b>	1.The material or divergence of shuttles are different 2.The frequency sensor cannot be inducted	1.Adjust the distance of metal plate 2.Clean the sensor

**Note:**1. The equipment is with two wheels to rotate and squeeze to shoot out the ball, so would slightly wear the ball, which is normal .  
 2. The dropping point would slightly deviated if the quality of the ball is different and the position of the machine is different.

**APP Download Code**

**1 Android**



(If the QR code scanning is abnormal, please visit the company's official website to download)

**2 IOS**



APP Store

“APP Store” Input “SS-Link”

SS-Link



Siboasi official Wechat

DONGGUAN SIBOASI Sports Goods Technology Co.,Ltd

Tel : 0769-8226 2773

Website: www.siboasi.com.cn

Eamil: ss@siboasi.com.cn

Address: No. 16, Fuma 1st Road, Chigang, Humen Town, Dongguan, Guangdong,China

**User manual**

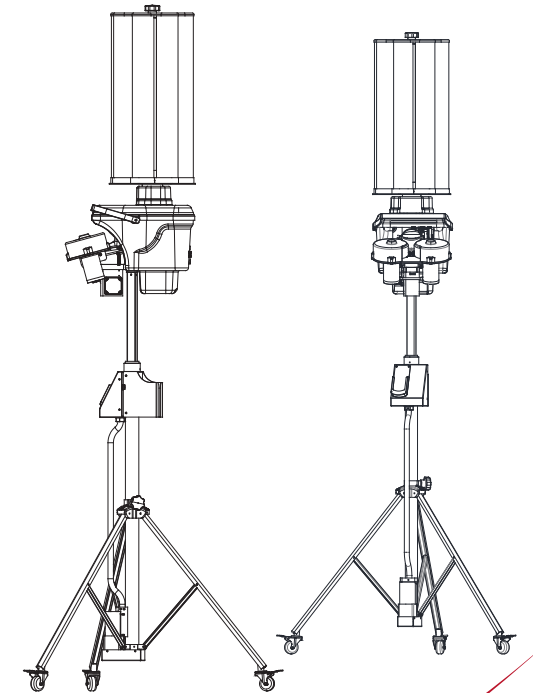
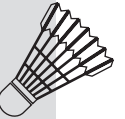

**Intelligent Badminton Equipment**

Model:SS-S4025A

## I Product Structure >>

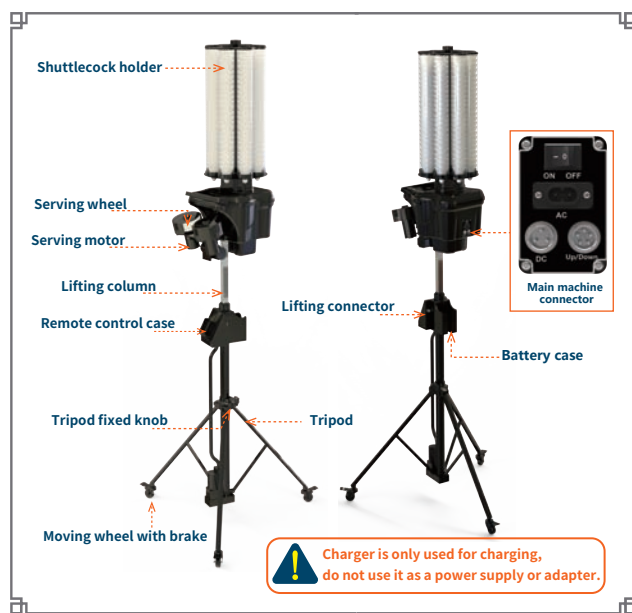

## II Product Installation >>

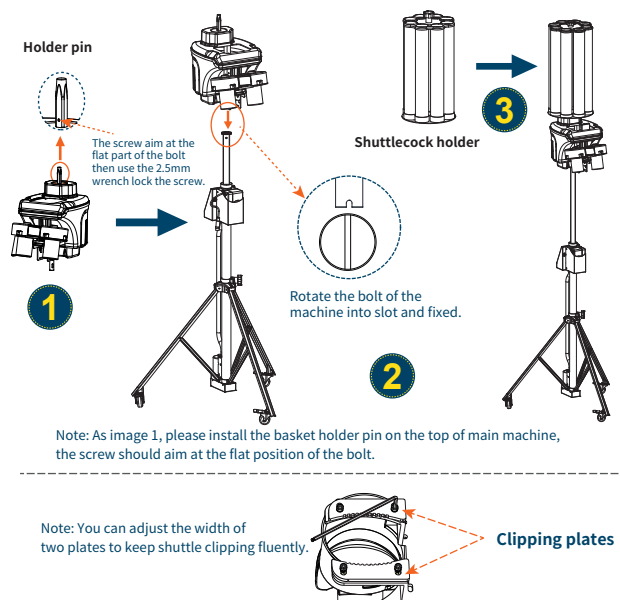

## III Remote Control Button instructions >>

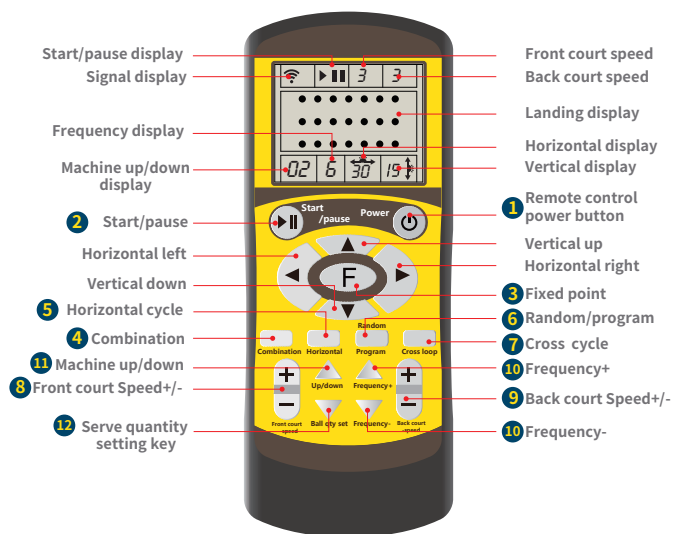

**Note:** please long press the power switch for 6S to initialization of remote controller Automatically within 30S after the machine is power up. any operation is invalid if the remoter without initialized, the maximum of 16 remoters can be matched.

## IV Remote control introduction >>

- Power button:** Long press switch button for 3s to start, 3s to turn off.
- Start/Pause button:** Press once for pause, once again for re-work.
- Fixed mode F button:** (1) Press "F" button to enter into fixed point mode, 1 default point; (2) Long press the "F" button on the remote control for 3 seconds to save the programmed fixed-point parameter; (3) Long press the "F" button of the remote control for 8 seconds, and the default parameters of the remote control will be restored to the factory setting.
- Combination mode button:** (1) Press the "combination mode" button to enter the combination mode. The equipment serves according to the point position displayed on the remote control. In this mode, Frequency, Front court speed, back court speed and lifting can be adjust; (2) Press the first square ball; Press the second medium shallow square ball; Press the third medium deep square ball; Press four vertical two-point cycles.
- Horizontal cycle button:** Short press the horizontal cycle key of the remote control, and press the horizontal random cycle for the first time; For the second time, press the wide two-point ball cycle; Press the middle two-point ball cycle for the third time; Press the narrow two-point ball cycle for the fourth

time; Press the three-point ball cycle for the Fifth time; Press the front court ball horizontal random for the sixth time; Press the back court ball horizontal random cycle for the seventh time.

**6. Random / program button:** (1) Short press "random / program" on the remote control to enter the random serve of the whole court. In this mode, the serve speed and frequency can be adjusted, the number of balls can not be adjusted. (2) Short press "random / program" on the remote control for the second, third and fourth times to switch the default three groups of programming settings. Speed, frequency and ball count can be adjusted. (3) Long press "random / program" on the remote control to enter the user-defined programming mode. You can set up 21 landing points in the field. Press the up, down, left and right keys to adjust the landing point position, press "F" key to confirm, press Cancel again, long press to cancel all programming landing points. Short press "random/program" button to save and exit the programming mode.

**7. Cross cycle button:** Press "cross loop" on the remote control, and the medium shallow left deep ball for the first time; Press the medium deep press left shallow ball for the second time; Press the medium deep right shallow ball for the third time; Press the medium shallow right deep ball for the fourth time; Press the left deep right shallow ball for the fifth time; Press the left shallow right deep ball for the sixth time.

**8. Front court speed+/- button:** when the lifting is 1, gears 1-5 grade adjustable; when the lifting is 2, 1-6 grade adjustable.

**9. Back court speed+/- button:** 1-5 grade adjustable.

**10. Frequency +/- button:** 1-9 grade adjustable.

**11. Machine up/down button:** Adjust the height of the head.

(display 1 is down and display 2 is up)

**12. Number of balls button:** Adjust the number of placement serves.

(Ball count 1-10 optional)

## V Product parameters >>

Max input power	360W	Product color	Black
Power supply	100-240VAC 50/60Hz	Frequencny	1.2-5.5s/ball
Capacity	180pcs	Battery	DC 12V
Elevation angle	-15°~33°(±5°)	Horizontal angle	30°(±5°)
Lifting	0-70cm can be adjusted automatically	Shooting window height	155cm/225cm
Product weight	31Kg	Product Size	105x105x305CM

## VI APP Introduction >>

- Download and install "SS-Link" APP. (Note: Scan the QR code on the manual to download and install.)
- Turn on the bluetooth.
- Open "SS-Link", it would scan the current available devices automatically. (Picture 1)
- Click "SS-S4025A..." to connect with machine, it will enter to APP operation page. (Picture 2)

### Programming mode operation steps

- Point "add program", enter the self-defined programming name, and then click "light" on the screen to select the ball dropping point, Then point "save". (Picture 3, 4, 5, 6)
- Click the "mode" of the program just edited and saved, and then set the front court speed, back court speed, frequency, rise and fall and the number of balls. (Figure 7)
- Click "control" to return to the main operation interface.



Picture 1

Picture 2

Picture 3

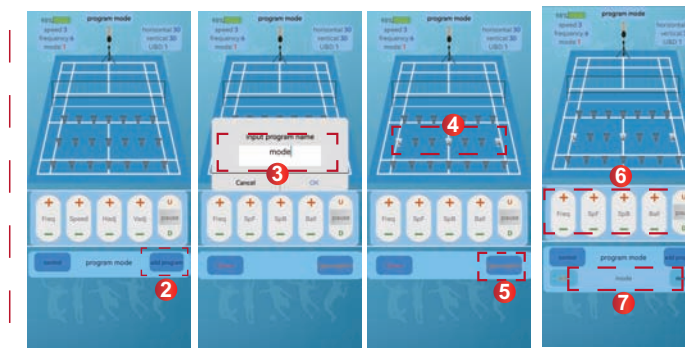

Picture 4

Picture 5

Picture 6

Picture 7

